

# Travel Limit Adjustment

## **WARNING**

To prevent **SERIOUS INJURY** or **DEATH** from improper Force Adjustment:

- Improper adjustment of travel limits will cause operation of safety reversal mechanism.
- If Travel limit adjustment is made, Force Adjustment may also be needed.
- After **ANY** adjustments, the Safety Reverse Test **MUST** be performed to ensure the door reverses on contact with a 1-1/2" thick object (2x4 laid flat).

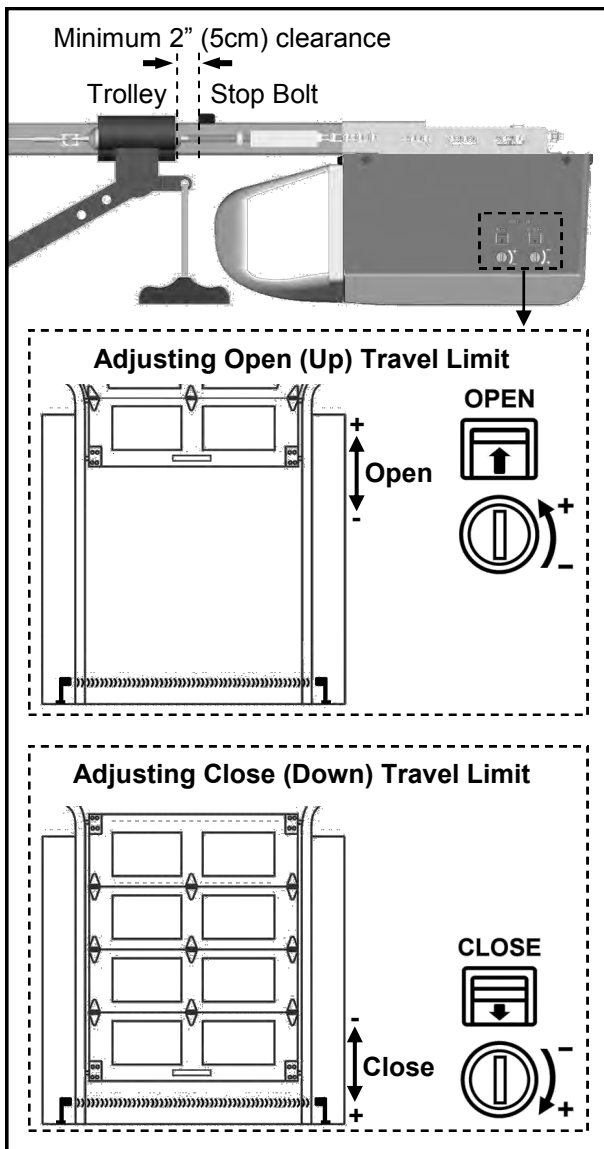

**If the door reverses unintentionally during closing, check below symptoms:**

1. The Photo Eye System may be improperly connected, misaligned or obstructed. The courtesy light will flash continuously for 30 seconds. Refer to **Troubleshooting** on P.22.
2. Binding door — Disconnect the door from the Opener by using the Emergency Release Handle. Open and close the door manually and check the following steps.
  - 2.1 If the door is balanced, refer to “Force Adjustment” to adjust Close force.
  - 2.2 If the door is unbalanced, binding or jammed, call a trained service person to adjust the door.

### **About Travel Limits**

Limit Adjustments regulate the position at which the door will stop when opening and closing.

**BEFORE** making any adjustments, operate the door by using the Push Button or Transmitter. Run the Opener through a complete cycle.

*If the door opens and closes completely without unintended reversing upon closing — NO adjustment is necessary.*

If the door does not open or close at desired positions, proceed with the instructions below to adjust the travel limits.

### **Adjusting Travel Limits**

Open and Close Limits can be increased (+) or decreased (-) by turning the corresponding screws on the Opener. Use a “flat head” screwdriver to make adjustments. One full turn of the screw is about 2” (5cm) of actual travel.

**NOTE:** The Opener motor includes an automatic thermal protection system which will shut down the motor in an overheat situation. The thermal protector will reset itself once the motor cools down. Opening and closing the Opener multiple times (in a short period of time) may cause the motor to overheat and shut down. If this happens, wait about 15 minutes for the motor to cool and retry operation.

### **Setting OPEN (UP) Travel Limit**

1. **CLOSE** the garage door by using either the Transmitter or Push Button.
2. Adjust the OPEN Limit Screw.
3. **OPEN** garage door and check for proper adjustment.
4. Repeat steps 1-3 until the door opens to the desired position. When the door is in the open position, make sure there is enough clearance for your vehicle(s), and there is a minimum 2” (5cm) gap between Trolley and Stop Bolt.
5. Perform **Safety Reverse Test** on page 18.

If the door does not open past 5 feet (1.5m), follow **Force Adjustment** on page 17 to adjust the Open Force.

### **Setting CLOSE (DOWN) Travel Limit**

1. **OPEN** the garage door by using either the Transmitter or Push Button.
2. Adjust the CLOSE Limit Screw.
3. **CLOSE** the garage door and check for proper adjustment.
4. Repeat steps 1-3 until door closes to the desired position.
5. Perform **Safety Reverse Test** on page 18.

# Force Adjustment

## **WARNING**

To prevent **SERIOUS INJURY** or **DEATH** from improper Force Adjustment:

- **DO NOT** adjust force to compensate for binding or sticking of the garage door. Call a qualified garage door service technician to make necessary adjustments in case of binding.
- **DO NOT** increase the force beyond minimum force required for closing the door. Too much force will cause improper operation of safety reversal mechanism.
- If either the Force or Travel limit adjustment is made, the other adjustment may also be needed.
- After **ANY** adjustments, the Safety Reverse Test **MUST** be performed to ensure the door reverses on contact with a 1-1/2" thick object (2x4 laid flat) .

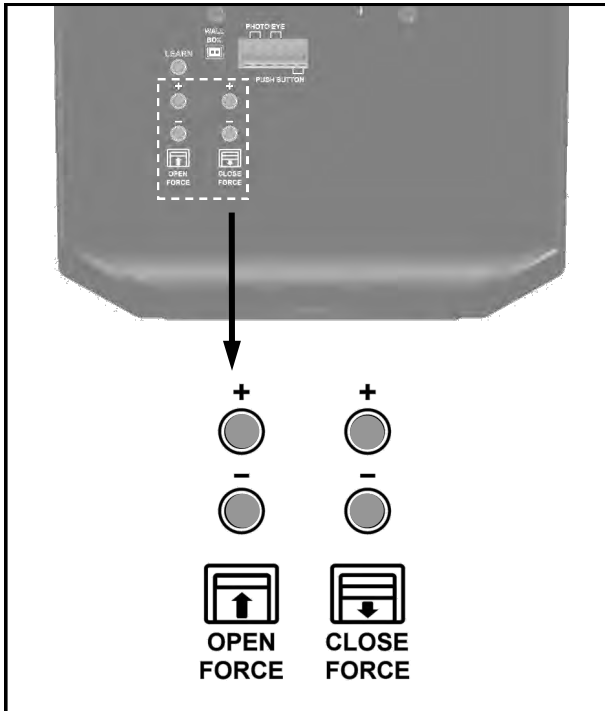

***For safe operation, the force setting should always be set at the MINIMUM FORCE required to run the door.***

### **Adjusting Force**

1. Force Adjustment controls are located on the rear panel of the Opener. The force adjustments regulate the amount of force required to open or close the door.
  2. Force Adjustment is applied only to compensate for the minor resistance caused by weather or other means.
- Note: Force is preset at level 6 for both Open and Close adjustments. The size and operating conditions of the garage door will determine the correct level of Force/Sensitivity. Weather conditions may also affect the operation of the door requiring further adjustments as needed.
  - Note: If the close force is set too light the Opener will reverse the door during closing. If the open force is set too light the Opener will stop the door during opening.
  - Note: There are 12 levels for open and close force settings. When either the maximum or minimum level is reached, the light will flash 6 times.
  - Never adjust the force setting by more than 1 level (1 press) at a time.

### **Setting Force**

#### **Setting Close Force**

1. If the door completes a full close cycle without reversing, decrease (-) the Close Force by 1 level at a time until the door reverses. If the door reverses during closing, increase (+) Close Force by 1 increment. The Close Force is now properly adjusted.
2. During the "door-close" cycle, the Opener will reverse if the force required to close the door is exceeded.

#### **Setting Open Force**

1. If the door completes a full open cycle without stopping, decrease (-) the amount of force by 1 level until the door stops during the opening. Once the door stops during opening, increase (+) Open Force by 1 increment. The Close Force is now properly adjusted.
2. During the "door-open" cycle the Opener will stop if the force required to open the door is exceeded.

# Installing Cable and Chain

## WARNING

To prevent SERIOUS INJURY:

- DO NOT connect power until instructed.
- Keep hands and fingers clear from sprocket during operation.
- Wear gloves when installing chain and cable.
- Keep hands and fingers away from joints and possible sharp edges.

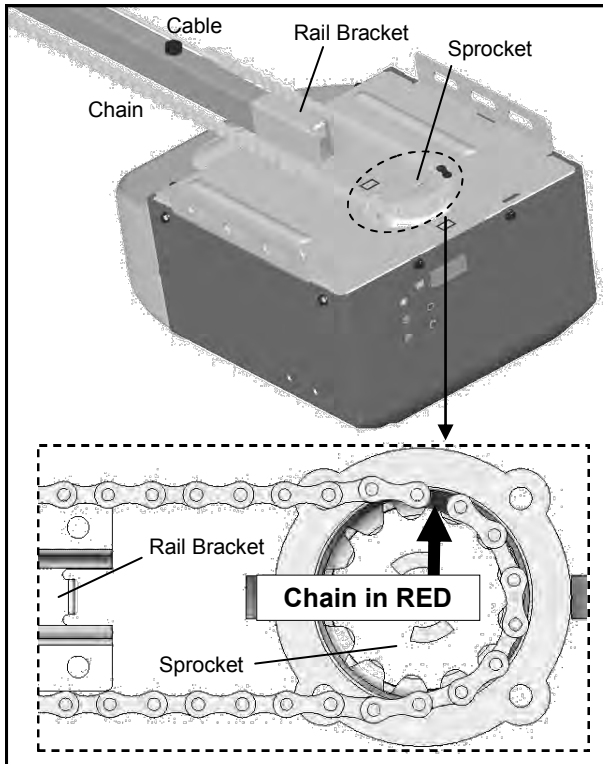

**Fig.1**

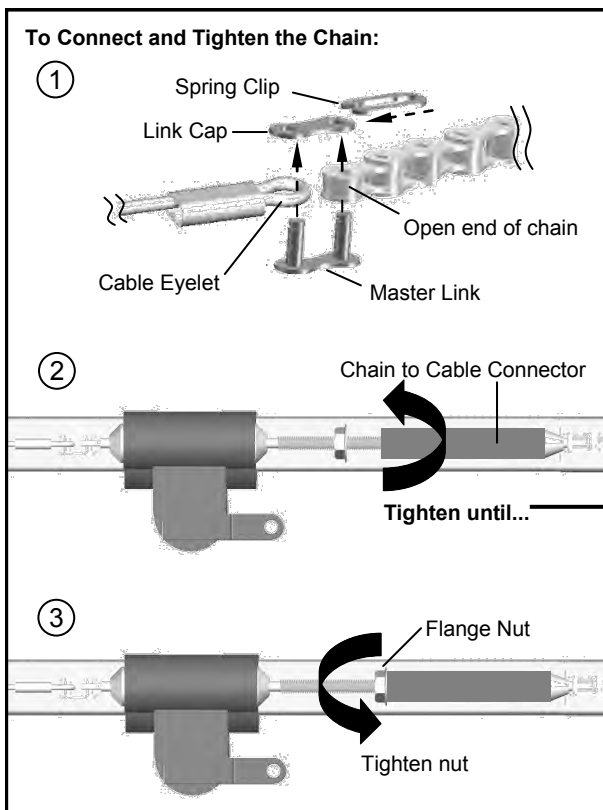

**Fig.2**

### To Install Chain

1. Pull the remaining chain along the rail toward the Opener.
2. A segment of chain marked in RED will be seen. Place this segment in the approximate location on the sprocket as shown in Fig.1.
3. When the chain is aligned properly around the sprocket, pull the Chain-to-Cable Connector towards the Trolley Shaft.

Follow steps shown in Fig.2 to connect & tighten the chain:

1. Align the open end of the chain to the Cable Eyelet and connect together using the Master Link Set.
2. Turn the Chain-to-Cable Connector on the Trolley Shaft until the chain is about 1/4" (6mm) above the base of the rail. Compare with the illustration below.
3. Tighten the Flange Nut on Trolley Shaft against the Chain-to-Cable Connector.

When the chain and cable are tightened around the rail and sprocket on the Opener, check and make sure the chain is properly aligned and not twisted. Attach the Sprocket Cover to the Opener as shown in Fig.3.

### Notice

During operation, it is normal for the chain to appear loose when the door is closed. If the chain returns to the position as shown below when the door is opened, the chain is adjusted properly. DO NOT re-tighten the chain.

When performing maintenance, always PULL the Emergency Release to DISCONNECT the door from Opener before adjusting the chain.

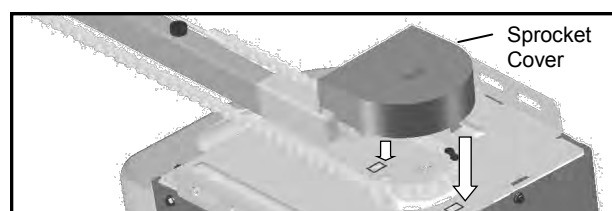
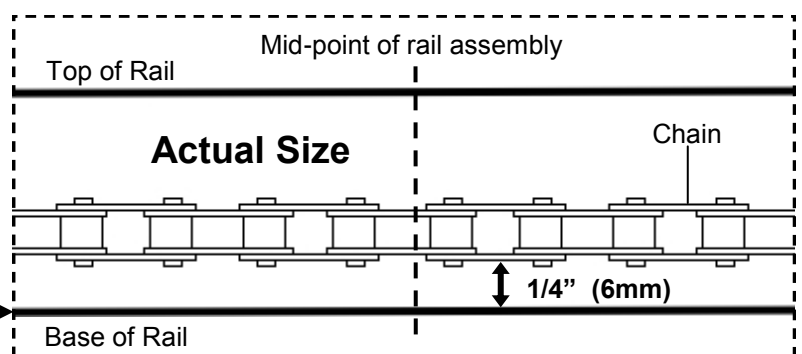

**Fig.3**