



For Use With Xtreme Garage™ Openers

### ⚠ WARNING

To Prevent SERIOUS INJURY or DEATH:

- Keep transmitter and battery out of reach of children.
- NEVER permit children to access the Push Button nor remote transmitters.
- Operate door ONLY when it is adjusted properly with no obstructions to door travel and is in clear sight.
- ALWAYS keep a moving door in sight until completely closed. NO ONE should cross the path of a moving door.



To reduce risk of fire, explosion or electric shock:

- DO NOT short circuit, recharge, disassemble or heat battery
- Replace with 9V batteries ONLY. Dispose of batteries properly.

## Setting Keyless Entry

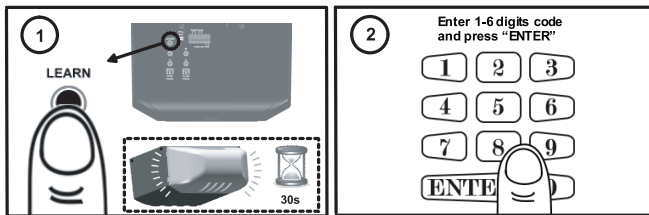

### To Add Personal Code:

1. Press/release "LEARN" button on the rear control panel, the courtesy light will glow with click\*. The unit is ready to accept a transmitter in the coming 30 seconds.
2. Enter 1 - 6 digit(s) personal code on Keyless Entry within 30 seconds and press/release "ENTER" button.
3. Courtesy light flashes twice indicating personal code is stored in memory.

Up to 20 personal codes (including 1-button transmitters) can be added to the unit by repeating the above procedures.

If more than 20 personal codes are stored the 21st code entered will replace the 1st code stored.

\* If the courtesy light is already on it will flash once and will stay on for 30 seconds.

### Operation:

To access the door, enter a pre-stored personal code and press "ENTER". Within 20 seconds, "ENTER" button can be used to stop or reverse the door.

If code is incorrectly entered press the "ENTER" and re-enter code.

"ENTER" may be pressed in advance to illuminate the keypad keys.

### Removing ALL Personal Code(s):

To remove ALL personal code(s) and /or transmitters from memory, press and hold the "LEARN" button between 5-10 seconds. The courtesy light will flash 7 times, indicating ALL codes/transmitters have been removed from memory.



For Use With Xtreme Garage™ Openers

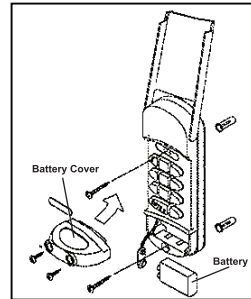

### Mounting the Keyless Entry:

On door jamb face outside your garage, locate Keyless Entry within sight of door at minimum height of 5 feet (1.5m), ensure it is away from reach of children and moving parts of door and hardware. Test the reception of the Keyless Entry before mounting. Change location for better reception if necessary.

Use the mounting holes on the Keyless Entry as template to mark position on the mounting surface. When installing to a wooden surface use the screws provided. When installing to a drywall surface, drill holes and use the drywall anchors provided.

### Replacing Keyless Entry Battery:

To replace battery, remove the battery cover by loosening the two screws located on the battery cover. Replace the battery with a 9V battery.

## One - Year Limited Warranty

If, during normal use, this Xtreme Garage product breaks or fails due to a defect in material or workmanship within one year from the date of original purchase, simply bring this item and its sales receipt back to your nearest Menards retail store for a free equivalent replacement within that one year.

### This warranty:

- (1) excludes expendable parts including but not limited to light bulbs and/or batteries;
- (2) shall be void if this product is used for commercial and/or rental purpose; and
- (3) does not cover any losses, injuries to persons/property or costs.

**This warranty does give you specific legal rights and you may have other rights, which vary from state to state.**

### Customer Service:

[www.gdohelp.com](http://www.gdohelp.com)

1-877-GDO-4402

1-877-436-4402

This device complies FCC Rules for HOME OR OFFICE USE. Operation is subject to the following two conditions: (1) this device may not cause harmful interference, and (2) this device must accept any interference received, including interference that may cause undesired operation.